

### 1. DESCRIPTION.

Electrowelded reinforcement with high ductility (HD) type B450C, made from hot rolled steel rods, constituted from close brackets with 4 welds or upon request with longitudinal bars.

### 2. CHEMICAL COMPOSITION.

	Limit	C %	P %	S %	N %	Cu %	Mn %	Ceq %
PITTINI	Max	0.22	0.050	0.050	0.012	0,80	/	0.50

Note: It is permitted a maximum value of C=0.25% if the maximum value of Ceq ≤ 0.48%

### 3. MECHANICAL PROPERTIES AND DIMENTION TOLLERANCES.

Steel Grade	Ø [mm]	Weight Tol. [%]	Length Tol. [mm]	Re min [MPa]	Rm min [MPa]	Rm/Re min	Rm/Re max	Re/Re nom	Agt min [%]	Bend Test
B450C	8 ÷ 14	± 4.5 *	0 ÷ 100	450	540	1.15	1.35	1.25	7.5	**

**NOTE:**

\* for  $\phi \leq 8$  the deviation is  $\pm 6\%$ .

\*\* according to D.M. 17/01/2018.

For cold deformed steels, tested after artificial ageing according to D.M. 17/01/2018.

### 4. PACKAGING.

In beam that have a minimum value of length like 2m with brackets

n° pieces/beam = (in operation of the section)

n° brackets/beam = (1 each 2m, minimum 2)

### 5. STANDARD IDENTIFICATION.

Each beam is identified with a label showing:

MANUFACTURER  
REFERENCE LEGISLATION  
CLIENT  
ORDER NUMBER  
BATCH CODE NUMBER  
TYPE OF PRODUCT  
DIMENSIONAL FEATURES  
PRODUCT WEIGHT  
DATE OF PRODUCTION E

### 6. STANDARD CERTIFICATION.

Copy of qualification issued by the Central Technical Services.

Documents in according to D.M. 17/01/2018

On request quality certificate according to UNI EN 10204:2005

### 7. APPROVALS

Ministry of Infrastructure and Transport.



### 8. STANDARD LAYOUT

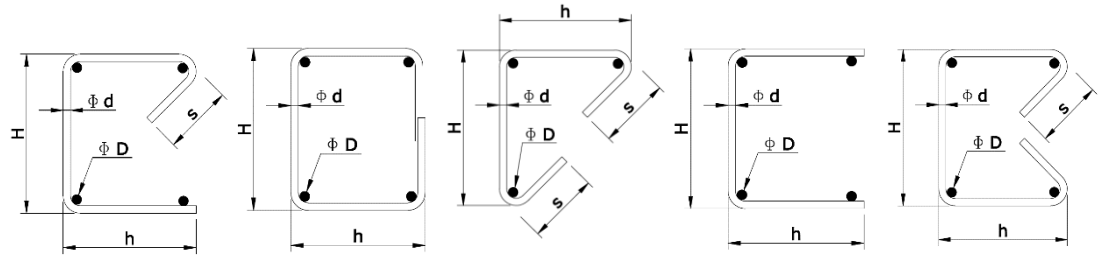

Dimensioni	SEZIONE			Spunt.	$\phi$ Long.	$\phi$ St.	Passo	Lung.	Sporg.	
	h	x	H						s	D
Min	100	x	80	65	8	6	150	2	50	50
Max	250	x	250	\	14	6	1000	13,6	1000	1000